

**ROOM LEGEND**

300	ELEV LOBBY	354	GRAD OFFICE
300A	ELEV	356	T & F SUPPORT
300B	ELEV	357	EGR141
301B	COPY/FAX/ PANTRY	358	THERMO LAB
301C	FILES	359	LAB MANAGER/ ELECTRONICS SHOP
301D	ASSOCIATE DEAN	360	FLUIDS LAB
301E	GRADUATE COORDINATOR	361	SHARED FACULTY OFFICE
301F	DEAN	363	INFORMAL LEARNING LAB
301G	EXECUTIVE SECRETARY	364	BIO ENGINEERING DRY LAB
301H	DEVELOPMENT	365A	TOCOMM
301J	BUDGET MANAGER	365B	FAMILY TOILET
301K	CONFERENCE	365C	ELEC
312	FACULTY OFFICE	365D	WOMENS
314	FACULTY OFFICE	365E	MENS
316	FACULTY OFFICE	366	BIO ENGINEERING WET LAB
320	FACULTY OFFICE	367	STAR #2
321	FACULTY LOUNGE/COPY	370	ENERGY LAB
322	FACULTY OFFICE	371	INFORMAL LEARNING CORRIDOR
324	FACULTY OFFICE	391	CORRIDOR
325	SHARED FACULTY OFFICE	392	CORRIDOR
326	FACULTY OFFICE	393	CORRIDOR
328	FACULTY OFFICE	396	MECHANICAL
330	FACULTY OFFICE	397	ROOFTOP LAB
332	FACULTY OFFICE	398	STAR #3
334	FACULTY OFFICE		
338	FACULTY OFFICE		
340	FACULTY OFFICE		
341	JC		
342	FACULTY OFFICE		
344	FACULTY OFFICE		
346	GRAD OFFICE		
347	FACULTY OFFICE		
347	SEMINAR		
348	ADJ. FACULTY SHARED OFFICE		
350	INFORMAL LEARNING		
351	STAIR #1		
353	ELEVATOR LOBBY		
355A	ELEV.		

STATE OF MICHIGAN  
DEPARTMENT OF TECHNOLOGY, MANAGEMENT AND BUDGET  
FACILITIES AND BUSINESS SERVICES ADMINISTRATION  
DESIGN AND CONSTRUCTION DIVISION  
ROBERT C. HALL, P.E., NCARB, DIRECTOR

OAKLAND UNIVERSITY



SMITHGROUP JJR  
ARCHITECTS  
ENGINEERS  
PLANNERS  
INTERIORS

**SHEET NOTES**

A. REFER TO SHEET NOTES ON SHEET E2.1.1.

**KEYED NOTES**

E232 PROVIDE THE FOLLOWING SPARE CONDUITS:  
 (1) 2" TO ELEC. RM 273 (POWER)  
 (1) 2" TO ENERGY LAB 370 (POWER)  
 (1) 1 1/4" TO IDF 187 (TCOM)  
 (1) 1 1/4" TO ENERGY LAB 370 (TCOM)  
 ROUTE CONDUITS IN HIGH BAY CEILING SPACE.  
 PROVIDE WITH FULL STRING CAP, WEATHER-TIGHT SEAL AND LABEL CONDUITS FOR FUTURE USE.

ENGINEERING CENTER  
LEVEL 03 POWER PLAN - AREA 3

ISSUED FOR	MPN
ISSUE #1	KIM
ISSUE #2	MM
ISSUE #3	MUM
ISSUE #4	MUM
ISSUE #5	MUM

DESIGNED	MPN
DRAWN	KIM
CHECKED	MM
APPROVED	MUM

ISSUED FOR	PRELIMINARY	CONSTRUCTION	FINAL RECORD
	<input type="checkbox"/>	<input type="checkbox"/>	<input type="checkbox"/>

IDENTIFICATION NO.	33211155-0001
FILE NO.	33211155-0001
FIRE SAFETY NO.	XXXX-XX
OU PROJECT NO.	70484
SG PROJECT NO.	22645-000

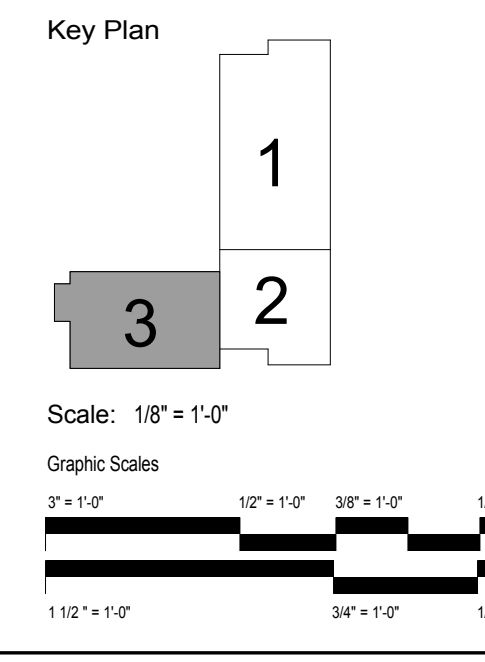

SHEET NO. E2.3.3